

ROHS Compliant

REVISIONS

RevNo	Description	Date	Revision	Mender
1	Add one ferrule for 735A-plenum cable	2011/03/22	A2	CKQ
2				

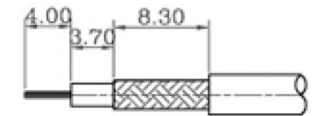
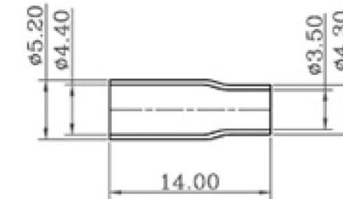
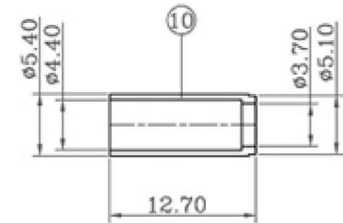
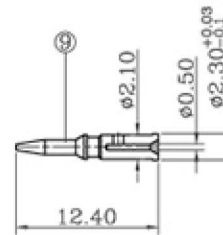
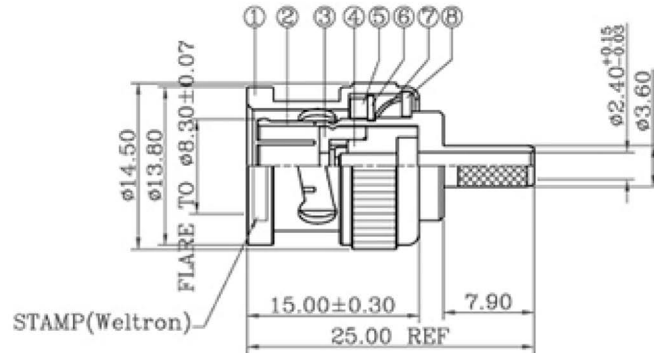

RECOMMENDED  
CABLE STRIPPING DIM'S

44-290-735A-75

NOTES:FINISH (PLATING THICKNESS IN MICRO-INCHES)

- 1.BRASS PER QQ-B-626
- 2.NICKEL PL.100 MIN. THICK OVER COPPER STRIKE
- 3.GOLD PL.3 MIN THICK OVER NICKEL PL.100 MIN. THICK OVER COPPER STRIKE
- 4.JIS H 3250,C 2700

- 1.CRIMPED FERRULE  
HEX CRIMP SIZE .187"
- 2.CRIMPED CONTACT PIN  
HEX CRIMP SIZE .068"

ITEM	DESCRIPTION	MATERIAL	Q'TY	FINISHED
10	FERRULE	NOTE 4	1	NOTE 2
9	CONTACT PIN	NOTE 1	1	NOTE 3
8	WASHER	IRON	1	NOTE 2
7	SPRING	65Mn	1	NATURAL
6	RETAINER RING	65Mn	1	NOTE 2
5	GASKET	RUBBER	1	RED
4	INSULATOR	POM	1	NATURAL
3	INSULATOR	POM	1	NATURAL
2	BODY	NOTE 1	1	NOTE 2
1	SHELL	NOTE 1	1	NOTE 2

<b>weltron</b> ®				TITLE		
				BNC CRIMP PLUG 75 OHMS FOR 735A,735A-plenum CABLE		
PART NO.	44-290-735A-75	UNITS	MM	UNLESS OTHERWISE SPECIFIED TOLERANCES:	DESIGNED	<i>Xwj</i>
MODEL NO.		SCALE	FIT		0.5-15 = ±0.15 15-30 = ±0.30 30-120 = ±0.60 >120 = ±1.00	DRAWING
				ANGLES ±5°	CHECKED	<i>David</i>