

ALL DIMENSIONS ARE REFERENCE ONLY

REV	DESCRIPTION	DWN	DATE	APPROVED
A	ENGINEERING RELEASE	CZS	12/15/97	R. RICE
B	REMOVE P/N FROM CONN. / UPDATE SPECS & DWG FORMAT	CZS	03/03/03	JDMc

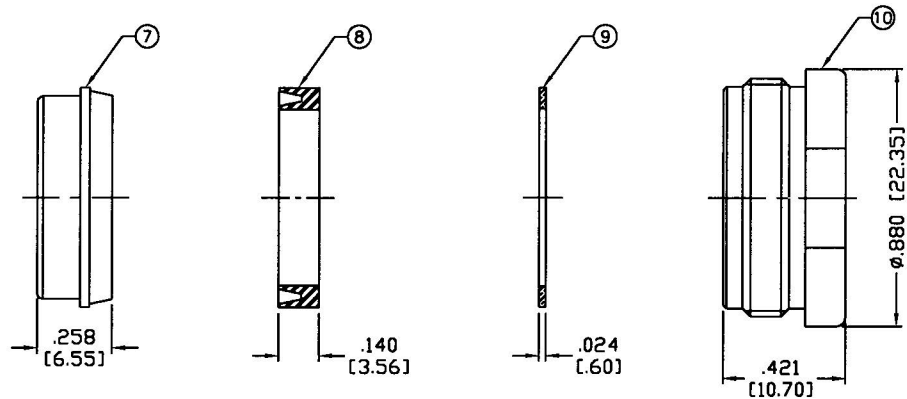
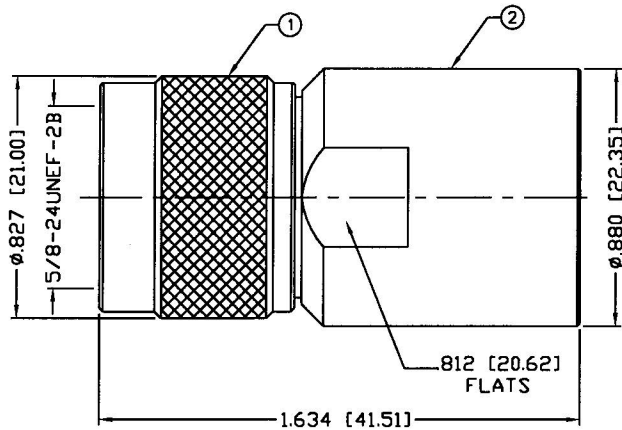

**SPECIFICATIONS:**

IMPEDANCE: 50 Ohms  
 FREQUENCY RANGE: 0-11 GHz  
 WORKING VOLTAGE: 1K V rms Max. @ Sea Level  
 VSWR MAX: 1.3  
 INSERTION LOSS(dB):  $0.06 \times \sqrt{f(\text{GHz})}$   
 CONTACT RESISTANCE:  $\leq 6 \text{ m Ohm}$   
 INSULATION RESISTANCE: 5k M Ohms min.  
 TEMPERATURE RANGE: -65°C TO 85°C

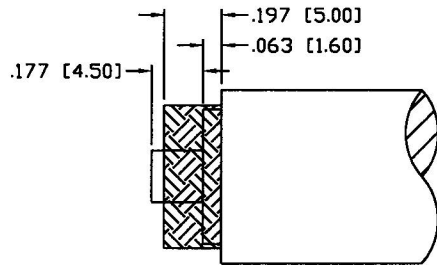

RECOMMENDED STRIPPING DIMENSIONS

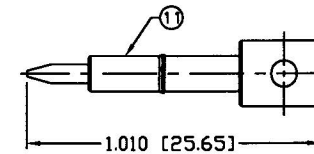

RECOMMENDED SOLDER

1	SHELL	1	BRASS	SILVER, 80μ"
2	BODY	1	BRASS	SILVER, 80μ"
3	GROUND RING	1	BRASS	SILVER, 80μ"
4	GASKET	1	SILICONE	---
5	RETAINING RING	1	SST	SILVER, 80μ"
6	INSULATOR	1	PTFE	---
7	CLAMP	1	BRASS	SILVER, 80μ"
8	GASKET	1	SILICONE	---
9	WASHER	1	BRASS	SILVER, 80μ"
10	BACK NUT	1	BRASS	SILVER, 80μ"
11	PIN	1	BRASS	GOLD, 3μ"
12				
13				
14				

008974	
DRAWN C. ZUNIGA	03/03/03
CHECKED <i>[Signature]</i>	3/3/03
ORJ DRAWN C. ZUNIGA	12/15/97

UNLESS OTHERWISE SPECIFIED:

- REMOVE ALL BURRS
- BREAK ALL CORNERS & EDGES .005 R. MAX.
- CHAMFER 1ST & LAST THREADS 45°
- SURFACE ROUGHNESS 63 FINISH MIL-STD-10
- DIAMETERS ON COMMON CENTERS TO BE CONCENTRIC WITHIN .002 T.I.R.
- ALL DIMENSIONS ARE AFTER PLATING.

DECIMALS .xxx±.003 [.08]  
 .xx±.005 [.13]

DIAMETER .xxx±.001 [.03]  
 .xx±.003 [.08]

DIMENSIONS ARE IN INCHES AND [MILLIMETERS]  
 UNLESS OTHERWISE NOTED TOLERANCES ARE:

PART NO. : <b>44-260-LMR600</b>			
<b>N-TYPE MALE CLAMP CONNECTOR</b> FOR LMR-600			
SIZE <b>A</b>	CABLE GROUP	DWG NO.	REV
SCALE: NTS		CAD FILE OUTLINE	SHEET 1 OF 1