

4

3

2

1

REVISIONS				
ZONE	REV	DESCRIPTION	DATE	DRAWN
	A	EG13026	08/22'13	NICK

## ISOMETRIC VIEW

JACK HOUSING

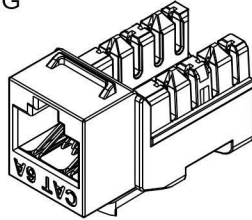

INSERT MODULE

WIRE CAP

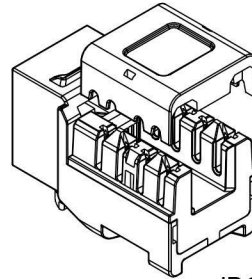

IDC MODULE

### TRANSMISSION PERFORMANCE

Meet all requirements specified in connecting hardware requirement of ANSI/TIA-568-C.2 Cat.6A

### ELECTRICAL

Electrical Insulation Resistance : 500 MΩ min. @ 100V d.c  
Dielectric Withstanding Voltage : 1000V d.c. or a.c. Peak Contact to Contact @ 60Hz for 1 minute,

### MECHANICAL

Insertion / Extraction Life : 750 Cycles Minimum  
IDC Wire Gauge : 22 ~ 24 AWG

### PHYSICAL

Housing : High-Impact, Flame-Retardant Plastic, UL 94V-0  
Spring Wire : Phosphor Bronze Alloy Plated With 50 micro-inch of Gold  
IDC : Phosphor Bronze Alloy With 100 micro-inch 100% Sn Alloy

### Assembly

The jack is compatible with only staggered snap-in Patch Panel.

## ASSEMBLY DIMENSION

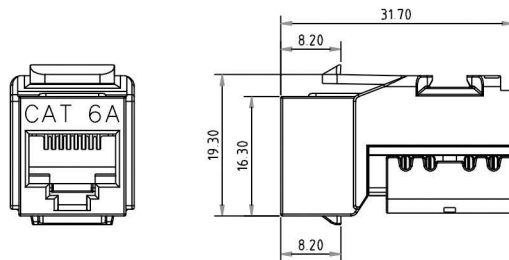
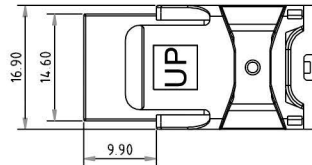

## COMPONENTS

ITEM	PART NAME	Q'TY
4	IDC MODULE	1
3	WIRE CAP	1
2	INSERT MODULE	1
1	JACK HOUSING	1

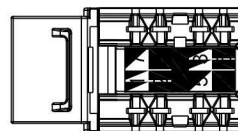
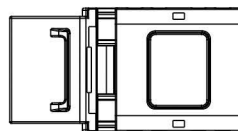

UNLESS OTHERWISE SPECIFIED: TOLERANCES			PROJECT ID	
INCH	MM	ANGULAR	FILE	DATE
.X ± .016	.X ± 0.2	X ± 1'	DRAWN NICK	08/19'13
.XX ± .008	.XX ± 0.1	.X ± .5'		
.XXX ± .004				
MATERIAL			CHECK	
SURFACE			APPROVED	
FINISH				

**weltron**®

SIZE	DRAWING NUMBER	PART NUMBER	REV
A4		44-678C6A-XX	A
SCALE	UNIT	SHEET	1 OF 1
	mm		