

ISOMETRIC VIEW

JACK HOUSING

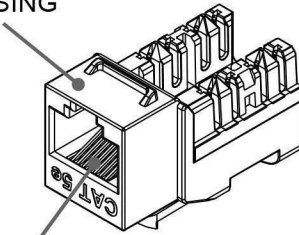

INSERT MODULE

WIRE CAP

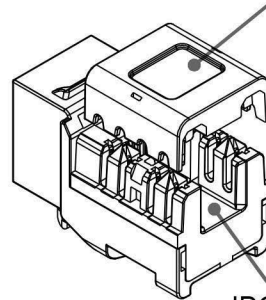

IDC MODULE

ASSEMBLY DIMENSION

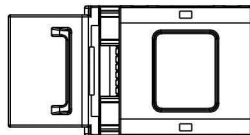
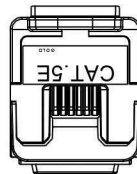
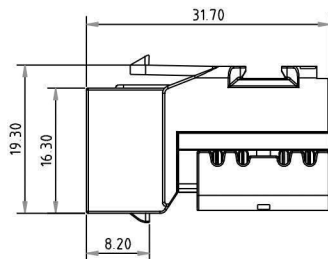
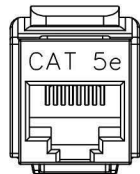
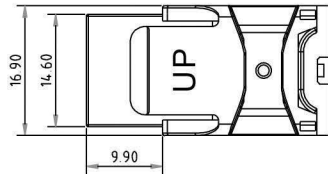

COMPONENTS

ITEM	PART NAME	Q'TY
4	IDC MODULE	1
3	WIRE CAP	1
2	INSERT MODULE	1
1	JACK HOUSING	1

REVISIONS				
ZONE	REV	DESCRIPTION	DATE	APPROVED
	A	EG09025	04/06'09	Nick
	B	ECN:ME09230	10/14'09	Yabe
	C	ECN:ME09373	9/23 '09	TOM
	D	ECN ME12084, E LOGO UP E-JACK	03/20/12	Allan

TRANSMISSION PERFORMANCE

Meet all requirements specified in connecting hardware requirement of ANSI/TIA/EIA-568-B.2 Cat.5e

ELECTRICAL

Electrical Insulation Resistance : 500 MΩ min. @ 100V d.c

Dielectric Withstanding Voltage : 1000V d.c. or a.c. Peak Contact to Contact @ 60Hz for 1 minute.

MECHANICAL

Insertion / Extraction Life : 750 Cycles Minimum

IDC Wire Gauge : 22 ~ 24 AWG

PHYSICAL

Housing : High-Impact, Flame-Retardant Plastic, UL 94V-0

Spring Wire : Phosphor Bronze Alloy Plated With 50 micro-inch of Gold

IDC : Phosphor Bronze Alloy With 100 micro-inch 100% Sn Alloy

UNLESS OTHERWISE SPECIFIED:

TOLERANCES	INCH	MM	ANGULAR
	.X ± .016	.X ± 0.2	X ± 1°
	.XX ± .008	.XX ± 0.1	.X ± .5°
	.XXX ± .004		

PROJECT ID

FILE

DATE

TITLE

Weltron®
CAT 5e 110 KEYSTONE JACK
25-PCS PER PACK

MATERIAL

DRAWN

Nick

04/06'09

SURFACE

CHECK

FINISH

APPROVED

SIZE

DRAWING NUMBER

PART NUMBER

REV

A4

44-678XX-CP

D

SCALE

UNIT

mm

SHEET

1 OF 1