

C/NO:

Material No.:

MODIFICATION

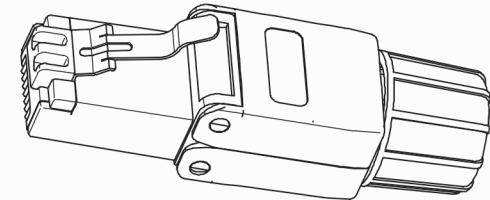
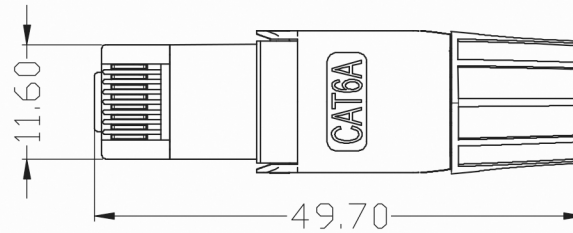
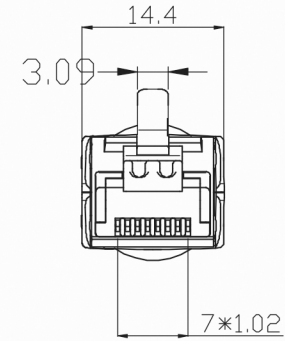
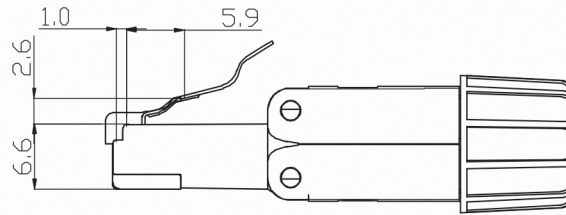
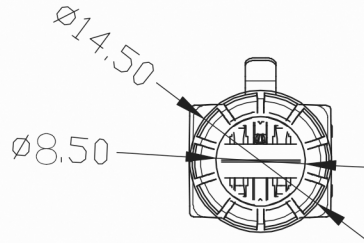

TYPE:

- 1. RJ45 CAT6A UNSHIELDED TOOLLESS PLUG
- 2. COLOUR: WHITE

CABLE MATCHED:

- 1. SOILD AND STRANDED
- 2. 22AWG/23AWG/24AWG

ELECTRICAL:

- 1. CONTACT RESISTANCE: 20m OHM
- 2. INSULATION RESISTANCE: $\leq 500M$ OHM @100 V DC
- 3. WITHSTAND VOLTAGE: DC1000V AC700V RMS 60HZ, IMIN
- 4. CAT6A PERMANENT LINK: CONFORM TO ANSI/TIA/EIA 568B. 2-10

ENVIRONMENTAL:

- 1. STORAGE: -40°/ +70°
- 2. OPERATION: -10°/ +60°

MECHANICAL:

- 1. PLASTIC MATERIAL: NEW PC
- 2. SHIELDED MATERIAL: ZINC ALLOY NICKEL PLATING
- 3. TERMINAL PINS: PHOSPHOR BRONZE, ZIN PLATING
- 4. RJ45 CONTACT LIFE: 750 TIMES MIN
- 5. IDC TERMINAL LIFE: 250 TIMES MIN

Weltron®

Unit

SCALE

MATERIAL

DWG NO

SHEET

TITLE

44-751-8C6A-FTP