

CHANGE			
EDIT	MODIFICATION	UPDATE DATE	SIGNATURE

NOTES:

1. Operation Temperature: -40°C ~ +85°C.
2. Electrical Characteristics:
 - 2.1 > Rated Current: 125V AC, 1.5A@25°C.
 - 2.2 > Contact Resistance: 20mΩ Max.
 - 2.3 > Insulation Resistance: 500MΩ Min, 100V DC/min.
 - 2.4 > Voltage Proof: 1000V AC/1 minute no breakdown.
3. Mechanical Characteristics:
 - 3.1 > Insertion Force & Withdrawal Force: 30N Max.
 - 3.2 > Durability: 750 cycles Min.
4. Environmental compliance:
 - 4.1 > the products are compliant with the RoHS, and REACH etc.

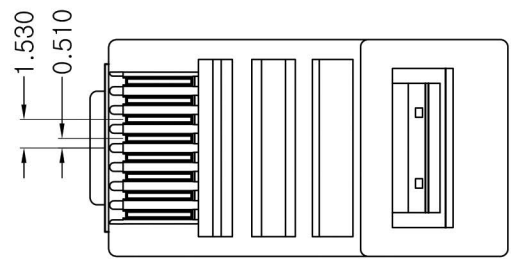
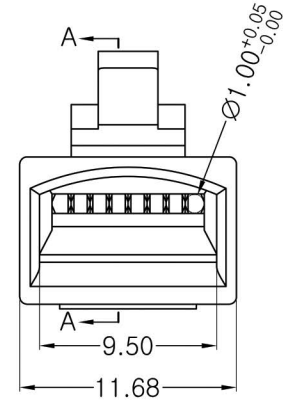
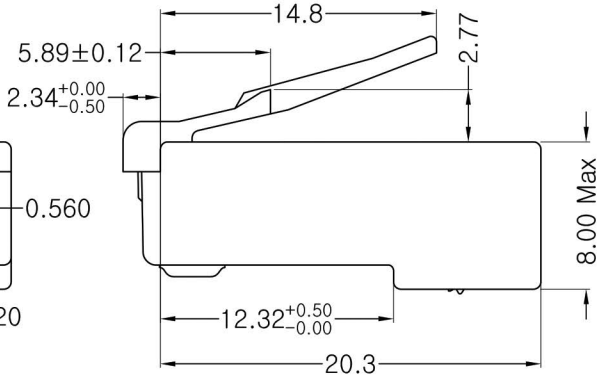
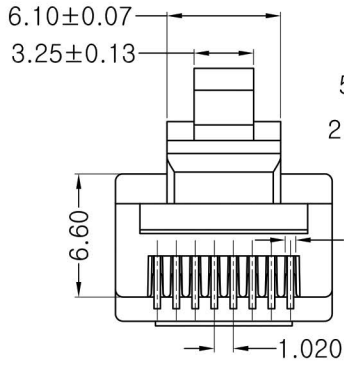
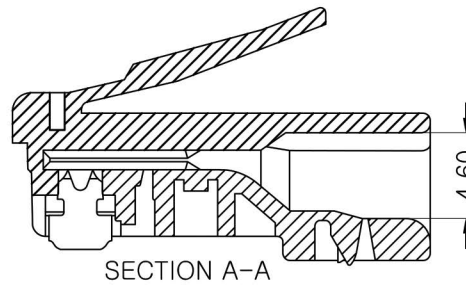
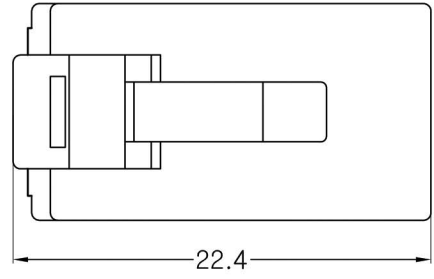

Weltron®

PRODUCT NO	44-751-8CB5E	DESCRIPTION	UNSHIELDED CAT5E RJ45 MODULAR PLUG						
MATERIAL	/	UNIT	mm	SCALE	1:1	DWG NO	MP11046	PLUG COUNT	50 PCS
DIMENSIONAL TOLERANCE			THIRD ANGLE PROJECTION		DRAWN		BOOT COUNT	50 PCS	
X. X ±0.2					CHECK		EDIT	A/0	
X. XX ±0.10					APPRO.		SHEET.	1/1	
X. XXX ±0.05									
ANGLE ±2°									

1	Modular Plug	Contacts	8PCS	/	<input type="checkbox"/> 2Prongs <input checked="" type="checkbox"/> 3Prongs	<input type="checkbox"/> G/F" <input checked="" type="checkbox"/> 15u" <input type="checkbox"/> 1u" <input type="checkbox"/> 30u" <input type="checkbox"/> 3u" <input type="checkbox"/> 50u" <input type="checkbox"/> 6u" <input type="checkbox"/> OTHER	Brass <input checked="" type="checkbox"/> Phosphor copper <input type="checkbox"/>
		Housing	1PCS	44-751-8CB5E	MP8P8C/UTP 1.00mm		94V-2 <input checked="" type="checkbox"/> 94V-0 <input type="checkbox"/>
NO.	NAME	QTY	PART NO.	DESCRIPTION			MATERIAL

CHANGE			
EDIT	MODIFICATION	UPDATE DATE	SIGNATURE

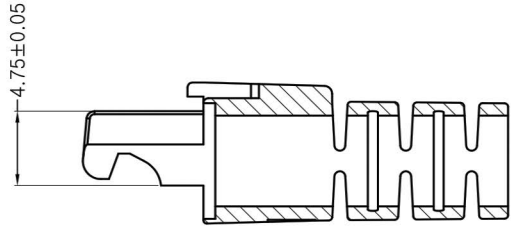
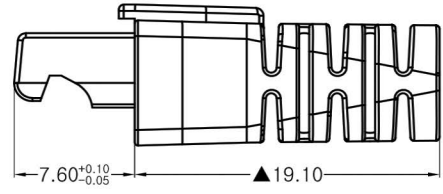
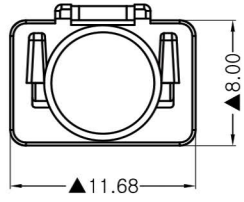
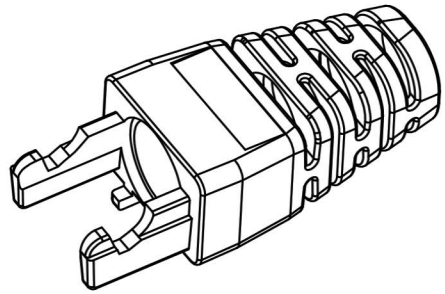
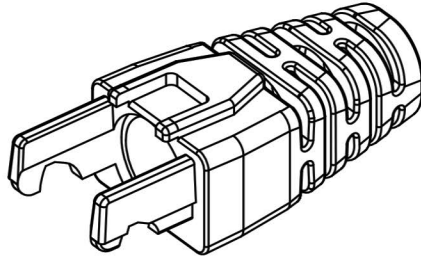
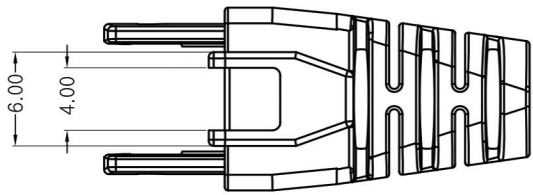

SECTION A-A

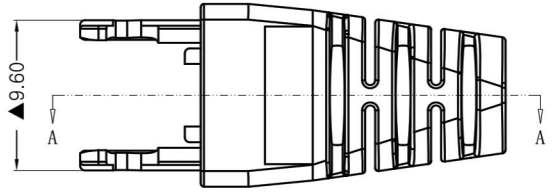
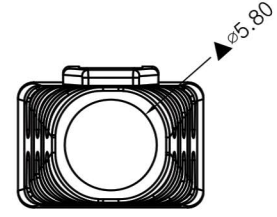

weltron®

PRODUCT NO			DESCRIPTION	CLEAR BOOT FOR CAT5E RJ45 (44-751-8CB5E)					
MATERIAL	PC	UNIT	mm	SCALE	NULL	DWG NO	SR00028	EDIT	A/0
DIMENSIONAL TOLERANCE			THIRD ANGLE PROJECTION			DRAWN		DATE	2018. 04. 25
X. X	±0.2				CHECK		DATE		
X. XX	±0.10				APPRO.		SHEET	1/1	
X. XXX	±0.05								
ANGLE	±2°								