

CHANGE			
EDITI	MODIFICATION	UPDATE DATE	SIGNATURE

NOTES:

1. Operation Temperature: -40°C ~ +85°C.
2. Electrical Characteristics:
 - 2.1 > Rated Current: 125V AC, 1.5A@25°C.
 - 2.2 > Contact Resistance: 20mΩ Max.
 - 2.3 > Insulation Resistance: 500MΩ Min, 100V DC/min.
 - 2.4 > Voltage Proof: 1000V AC/1 minute no breakdown.
3. Mechanical Characteristics:
 - 3.1 > Insertion Force & Withdrawal Force: 30N Max.
 - 3.2 > Durability: 750 cycles Min.
4. Environmental compliance:
 - 4.1 > the products are compliant with the RoHS, and REACH etc.

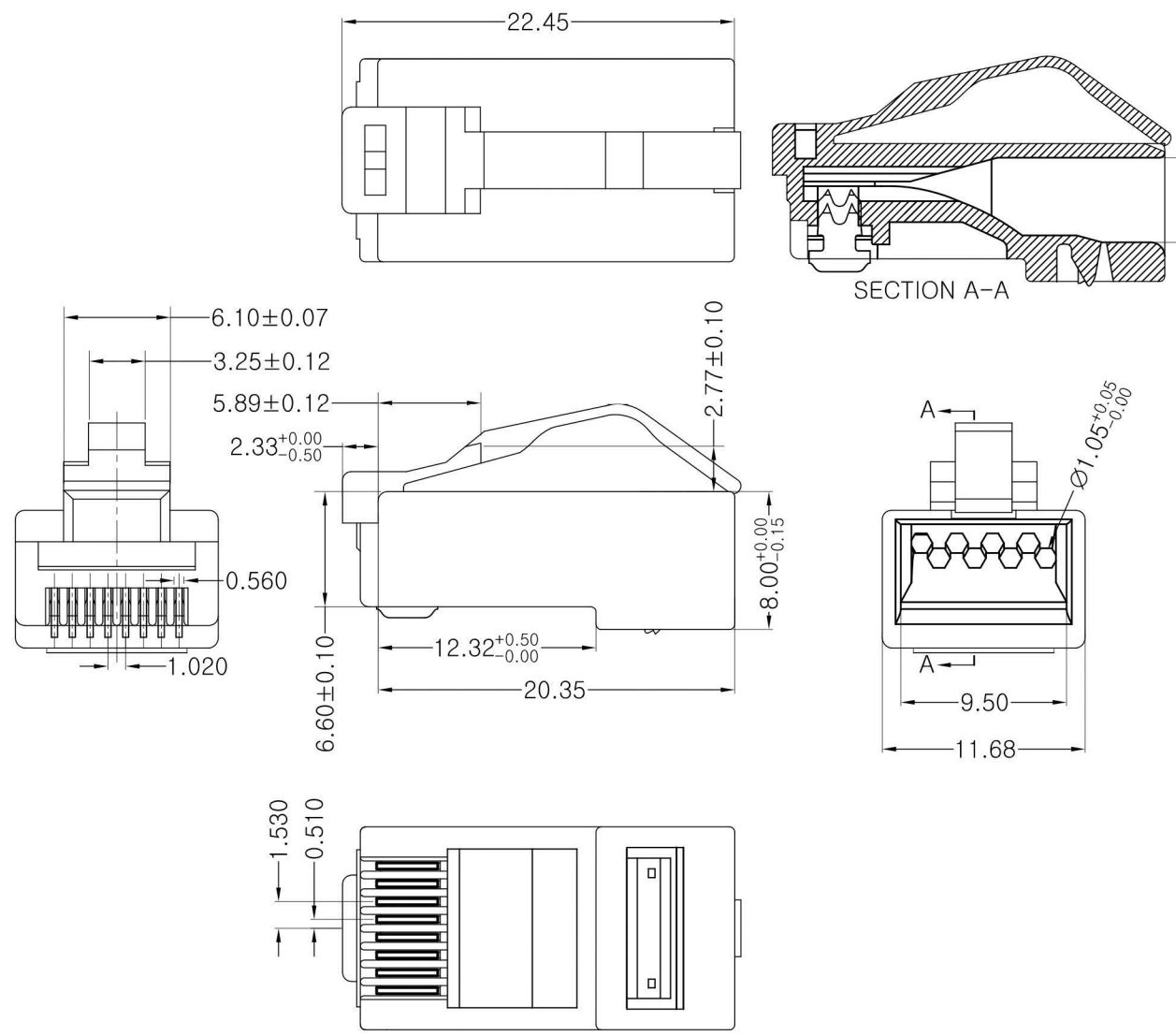

Weltron®

PRODUCT NO	44-751-8CB6		DESCRIPTION	CAT6/UTP/4 1.05mm		SHEET.	1/1
MATERIAL	/	UNIT	mm	SCALE	1:1	DWG NO	MP23020
DIMENSIONAL TOLERANCE			THIRD ANGLE PROJECTION		DRAWN	DATE	2018.04.27
X.X ±0.2					CHECK	DATE	
X.XX ±0.10					APPRO.	DATE	
X.XXX ±0.05							
ANGLE ±2°							

1	Modular Plug	Contacts	8PCS	/	<input type="checkbox"/> 2Prongs <input checked="" type="checkbox"/> 3Prongs	<input type="checkbox"/> G/F" <input type="checkbox"/> 15u" <input type="checkbox"/> 1u" <input type="checkbox"/> 30u" <input type="checkbox"/> 3u" <input type="checkbox"/> 50u" <input type="checkbox"/> 6u" <input type="checkbox"/> OTHER	<input type="checkbox"/> Brass <input type="checkbox"/> Phosphor copper
		Housing	1PCS	20*2051**	CAT6/UTP 1.05mm		<input type="checkbox"/> 94V-2 <input type="checkbox"/> 94V-0
NO.	NAME	QTY	PART NO.	DESCRIPTION			MATERIAL

CHANGE			
EDITI	MODIFICATION	UPDATE DATE	SIGNATURE

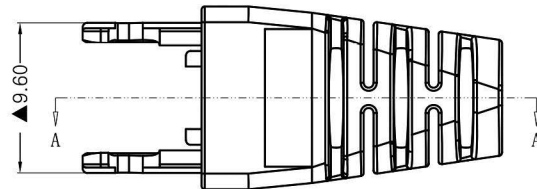
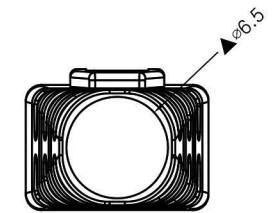
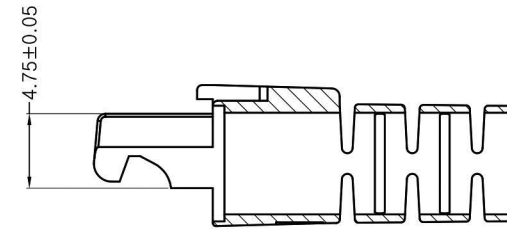
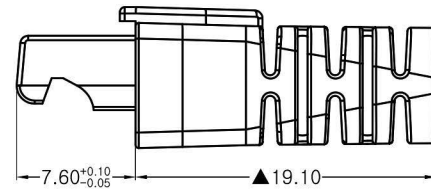
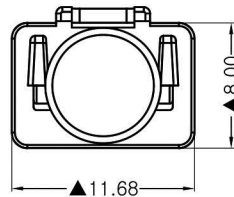
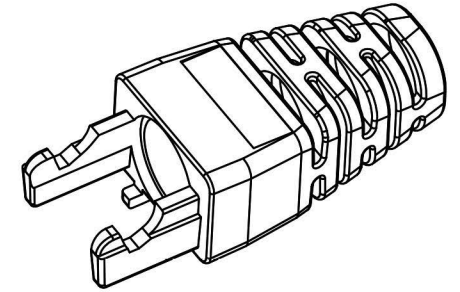
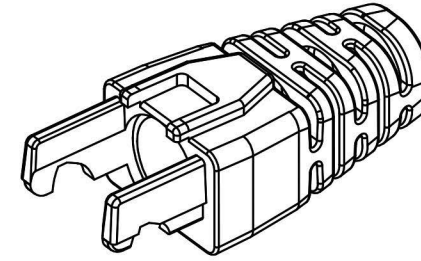
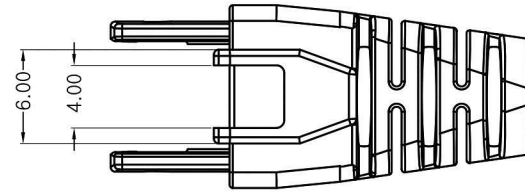

SECTION A-A

weltron®

PRODUCT NO	FOR: 44-751-8CB6	DESCRIPTION	JACKET /APERTURE 6.5mm	SHEET	1/1
MATERIAL	PC	UNIT	mm	DWG NO	SR00029
DIMENSIONAL TOLERANCE		THIRD ANGLE PROJECTION		DRAWN	DATE
X. X	±0.2			CHECK	DATE
X. XX	±0.10			APPRO.	DATE
X. XXX	±0.05				
ANGLE	±2°				