

REVISIONS				
ZONE	REV	DESCRIPTION	DATE	DRAWN
	A	EG11046	09/08'11	JASON

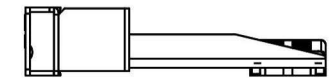
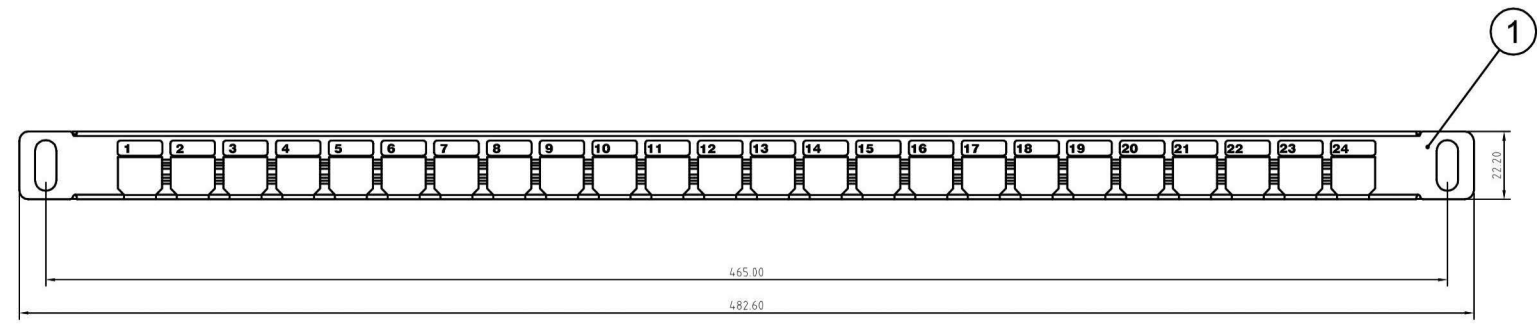
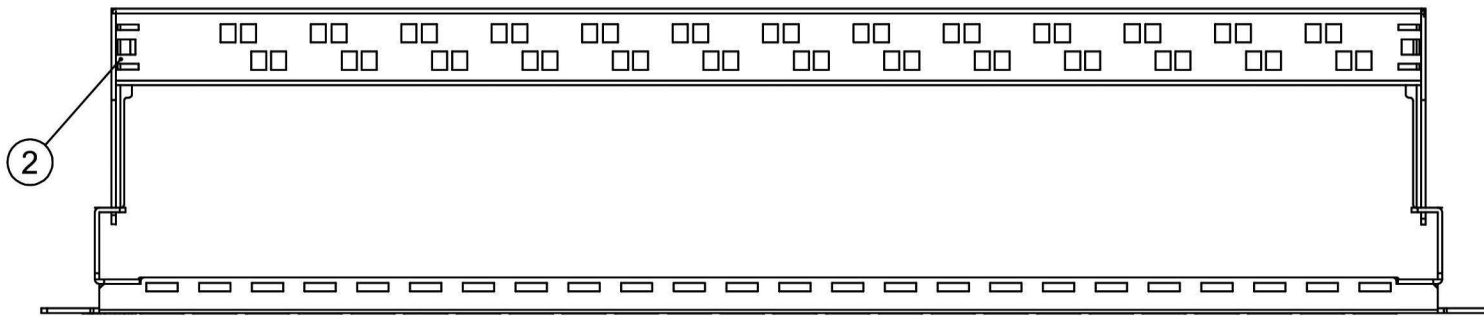

NO:	PART NAME	Q'TY
1	0.5U 24 PORT PATCH PANEL(FRONT)	1
2	BRACKET MOUNTING	1

UNLESS OTHERWISE SPECIFIED: TOLERANCES			PROJECT ID 2012K-FMH24-05	
INCH	MM	ANGULAR	FILE	DATE
.X ± .016	.X ± 0.2	X ± 1°	Z3338.dwg	
.XX ± .008	.XX ± 0.1	X ± .5°	DRAWN	JASON 09/07'11
.XXX ± .004			CHECK	
MATERIAL	APPROVED			
SURFACE				
FINISH				

Weltron®

PART NUMBER **90-024PPRLHD**

SIZE	DRAWING NUMBER	TITLE	REV
	Z3338	24 PORT PATCHPANEL	A

SCALE NON UNIT SHEET 1 OF 1

4

3

2

1

REVISIONS				
ZONE	REV	DESCRIPTION	DATE	DRAWN
	A	EG08056	10/9 '08	TOM

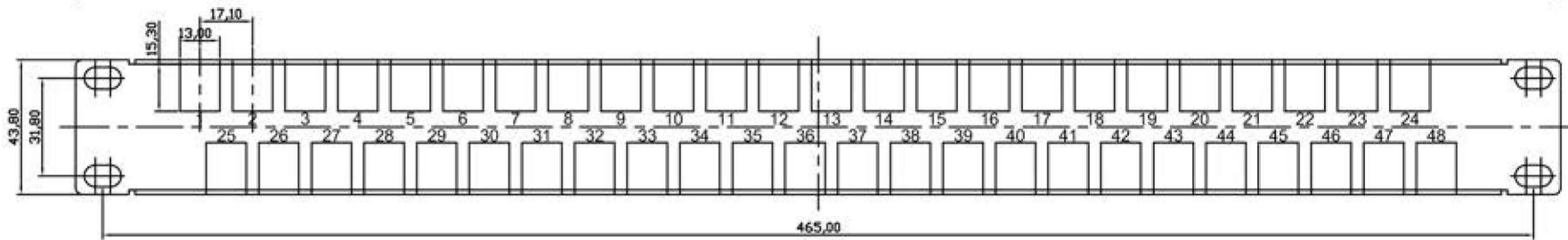
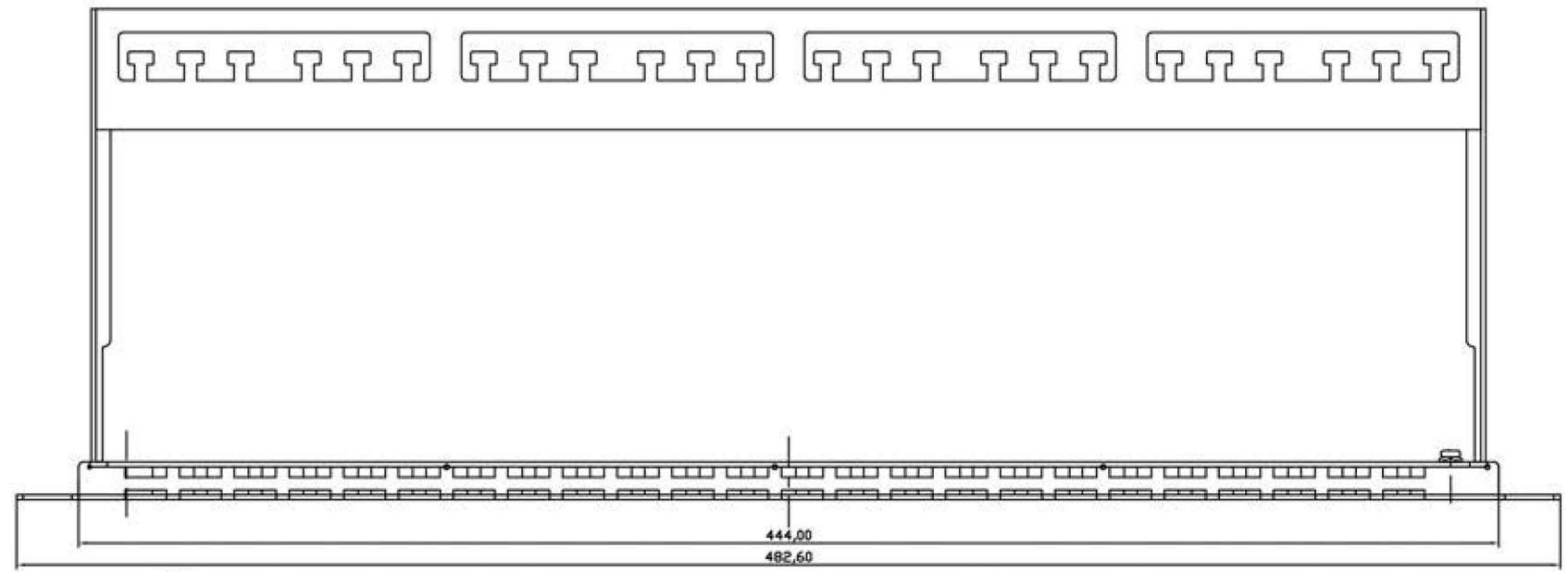
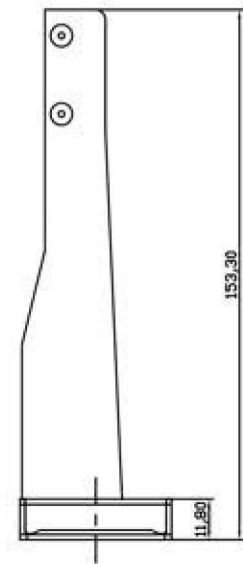
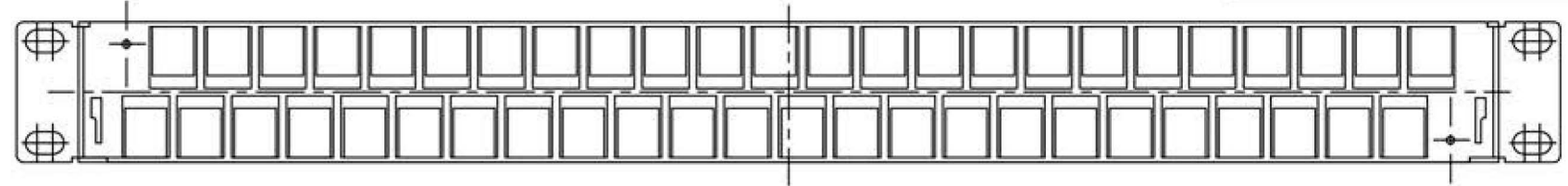

UNLESS OTHERWISE SPECIFIED: TOLERANCES			PROJECT ID 2012K-FD48 2022K-FD48-06	
INCH	MM	ANGULAR	FILE	DATE
.X ± .016	.X ± 0.2	X ± 1°	Z2662.DWG	
.XX ± .008	.XX ± 0.1	X ± .5°		
.XXX ± .004				
MATERIAL	DRAWN		PART NUMBER	
	TOM		90-048PPRLHD	
SURFACE	CHECK		SIZE	DRAWING NUMBER
			A3	Z2662
FINISH	APPROVED		TITLE	REV
			48 PORT PATCH PANEL	A
SCALE 1 : 1			UNIT mm	SHEET 1 OF 1

weltron®

90-048PPRLHD

48 PORT PATCH PANEL

SCALE 1 : 1 UNIT mm SHEET 1 OF 1